

FIXED POINTS (MODULAR ANCHORS)

Model FP1, FP2, FP3, FP4 + FP5

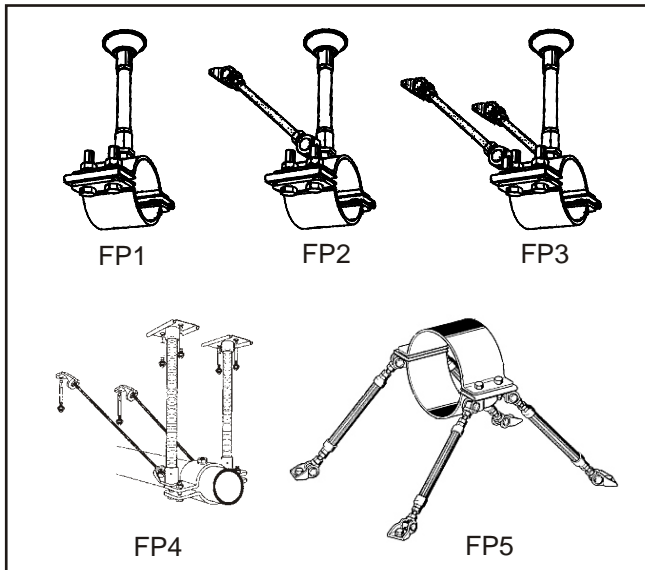

APPLICATIONS

These fixed points offer a modular approach to anchoring pipes from ceilings, floors and walls. Standard construction is from steel with BZP finish, but stainless steel can be provided upon request.

These may be attached to the building structure as follows:-

- Ceiling mounting
 - Floor mounting
 - Wall mounting for rising pipes
 - Wall mounting for horizontal pipes*
- *NB only when the pipe weight is supported by other means*

These models can be used accordingly on stainless steel, carbon steel or copper pipes for the following applications:-

- Low Temperature Heating (LTHW)
- Medium Temp. Heating (MTHW)
- High Temp. Heating (HTHW)
- Domestic Hot Water (DHWS)
- Steam and Condensate

Pipe Size DN (mm)	Clamp Ring [W x T] Fixing	Tightening Torque (Nm)	Height to Pipe Axis (mm)	Maximum Force (N)	Product Code (MODEL-BRACE-SIZE-HEIGHT-O.DIA.)
The pipe size DN, clamp ring and tightening torque for each model is the same irrespective of height to pipe axis, maximum force and bracing.			350	600	FP1(BZP)-0-###-0350-(###)
			500	9000	FP2(BZP)-M16-###-0500-(###)
			1000	8000	FP2(BZP)-M16-###-1000-(###)
			500	9000	FP3(BZP)-M16-###-0500-(###)
			1000	8000	FP3(BZP)-M16-###-1000-(###)
			500	18000	FP4(BZP)-M16-###-0500-(###)
			1000	16000	FP4(BZP)-M16-###-1000-(###)
			500	24000	FP5(BZP)-½-###-0500-(###)
			1000	4000	FP5(BZP)-½-###-1000-(###)
			500	35000	FP5(BZP)-¾-###-0500-(###)
			1000	14000	FP5(BZP)-¾-###-1000-(###)
			500	35000	FP5(BZP)-1-###-0500-(###)
			1000	32000	FP5(BZP)-1-###-1000-(###)
			e.g. FP1(BZP)-0-015-0500-(022) FP3(BZP)-M16-040-1500-(049) FP5(BZP)-½-050-0500-(061) FP5(BZP)-¾-100-1000-(114) FP5(BZP)-1-300-1500-(324)		
15 to 40	[80 x 5]	M16	50	The height to pipe axis and maximum force for each model is the same irrespective of pipe size.	
50 to 80	[80 x 6]	M16	80		
100 to 250	[100 x 6]	M16	100		
300 to 500	[100 x 8]	M16	100		

SPECIFICATION

FP1 - a steel base with female boss, pipe clamp with female boss for connection to the base with connector and support leg. Designed to clamp the pipe.

FP2 - similar to FP1, and has one bracing.

FP3 - similar to FP1, and has two bracings.

FP4 - similar to FP1, and has two support legs and two bracings.

FP5 - similar to FP1, and has four bracings, but no support leg.

FP#(BZP) - as above, but with formed BZP steel clamps.

FP#(SS) - as above, but with formed stainless steel clamps.

FP#(NYL) - as above, but with formed nylon coated steel clamps.

OPERATING PARAMETERS

FP#(BZP) and FP#(SS) models

Upper Temperature Limit = 200 °C

Lower Temperature Limit = 0 °C

FP#(NYL) model

Upper Temperature Limit = 100 °C

Lower Temperature Limit = 0 °C

Clamping forces of up to 35kN are possible, but be aware that the bending moments of threaded rods or tubes restrict the application to the maximum force stated. The angles at which the braces are affixed restrict the application, the maximum force stated above is based on all braces set at 45° to the structure (side elevation) and at 22.5° from the perpendicular (end elevation).

Note that all 4 clamp ring fixings must be tightened to the stated torque settings for the maximum force to be achieved.